

# *Pleasure-Way*



1986

Pleasure-Way is an attractive, high quality, efficient motorhome which offers complete comfort and dependability.

Built on a Chrysler Van chassis, the aerodynamic body design with a sleek fiberglass roof minimizes wind resistance, providing fuel economy and easy handling. The interior design is spacious and complete with all the comforts needed for long distance travelling.

Chassis options include 318 V8 engine, automatic transmission, chrome grill and bumpers, tinted glass package, dual low mount chrome mirrors, cruise control, tilt steering, deluxe wheel covers, gauge assembly, and heavy duty front springs.

### **Standard Conversion Features**

1. Low fiberglass roof with roof vent
2. Insulated walls and ceiling
3. 3 swivel, reclining captain's chairs
4. Microwave Oven
5. Automatic forced air furnace
6. 2.9 cu. ft. 3-way fridge
7. 2-burner LP stove
8. 110/12V 30 amp converter
9. Auxiliary battery
10. 12V water pressure system with city water connection
11. 60 litre fresh water tank
12. Fresh water flush toilet
13. Dual holding tanks
14. 30 litre propane tank

Options include chassis air and a fourth captain's chair in lieu of the TV stand.

All Pleasure-Way motorhomes are manufactured with the highest quality materials available. Paneled insulated walls and an automatic forced air furnace provide welcome comfort in cool weather.

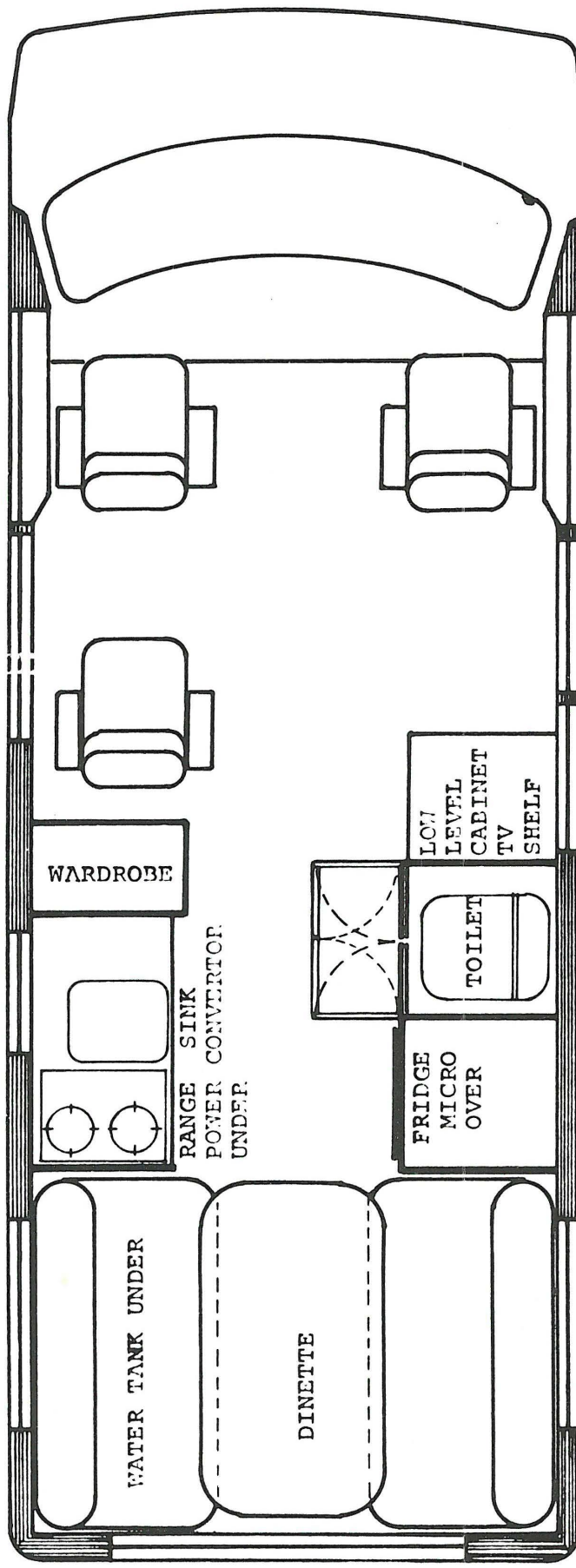

All Pleasure-Way products are CSA approved and are warranted by both the vehicle manufacturer (1 year or 20,000 kilometres) and our own 1 year limited warranty on the manufactured conversion.

**Pleasure-Way Industries Ltd.**  
**Saskatoon, Sask.**

Your Pleasure-Way Dealer Is:

GLENWOOD TRAILER SALES LTD.  
111 GYLES PLACE  
AIRPORT INDUSTRIAL  
SASKATOON, SASK.